

General Information

Exhibition Hours

Build-up:

Sunday, September 21 2 p.m.– 6 p.m.

Break-down:

Wednesday, September 24 2 p.m.– 6 p.m.

Sunday, September 21 7 p.m.–10 p.m.

Monday, September 22 9 a.m.–10 p.m.

Tuesday, September 23 9 a.m.– 6 p.m.

Wednesday, September 24 9 a.m.– 2 p.m.

Space is assigned on a first come, first served basis. Allocation will be in the order of the receipt of full payment. Late applications will be accepted subject to space availability.

Language

The official language of the symposium is English.

Venue

Freiburg, known as the capital of the black forests, combines the flavour of its medieval city center with modern urban life. Located in the triangle of Germany, France and Switzerland, it is well known for its mild climate and warm evenings in fall to visit restaurants and beer gardens and learn about „savoir vivre“ with local Baden cuisine and wines. The Black Forest and the wine regions around offer plenty of opportunities to enjoy sports and recreation activities as well as entertainment in concerts or theatres. The conference will be held in the conference center (Freiburg Concert Hall/Konzerthaus Freiburg) that is easy accessible with public transportation. It is located in walking distance to the main station, many hotels and the city center.

Further information about Freiburg:

www.freiburg.de

Further information about the University of Freiburg:

www.uni-freiburg.de

Contact

Ms. Nina-Sophie Henschel

VDE Conference Services

Stresemannallee 15

60596 Frankfurt

Germany

Phone: +49 (0) 69 63 08 275

Fax: +49 (0) 69 96 31 52 13

E-mail: vde-conferences@vde.com

Latest information on the conference and exhibition will be provided on the IFESS 2008 homepage at www.ifess2008.de.

Exhibition Floorplan

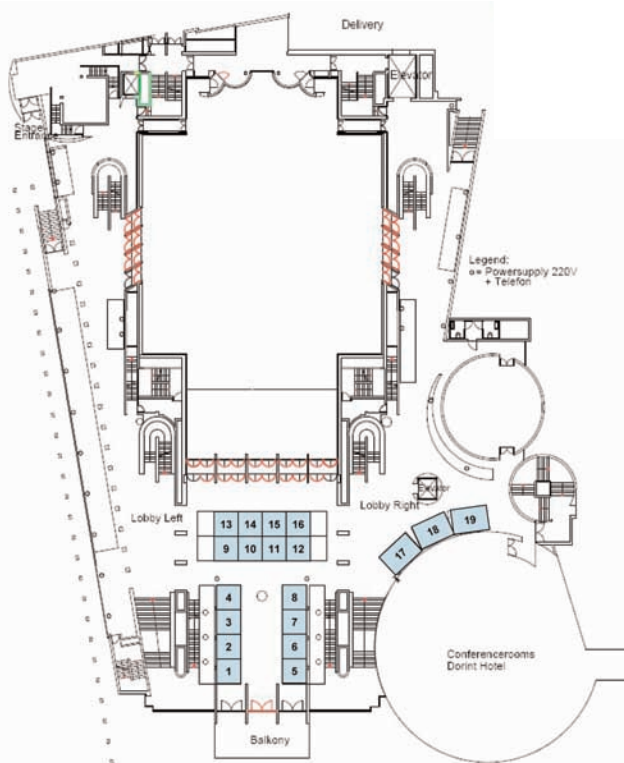

Call for Exhibition

IFESS 2008 –
from movement to mind



13th Annual International
FES Society Conference

Freiburg Concert Hall
Freiburg, Germany
September 21–25, 2008



Invitation to exhibit

At the 13th Annual International FES Society Conference to be held in Freiburg from September 21–25, 2008, exhibition space will be provided for biomedical science and technology related products, tools and services. The exhibition will provide a venue for organizations and companies to make contact with the international research community and innovative medics (approx. 300 participants).

The program committee decided to install two categories of exhibitors: industrial exhibitors and exhibitors of non-profit organisations.

Why exhibit?

IFESS 2008 is the leading annual conference on Functional Electrical Stimulation. It is a unique opportunity for companies to meet scientists and physicians. The Exhibition is open from Sunday, 7 p.m. until Wednesday, 2 p.m.

The IFESS 2008 Conference and Exhibition attracts influential decision makers who attend the technical sessions to present their work and learn about the latest technological and medical developments. While they come to network with colleagues and peers, they will automatically visit the exhibition of products, tools and services and many will make important purchase decisions. As an exhibitor, you will have the unique opportunity to get in on the ground floor and market your products and services to a captive audience of buyers, designers and influencing researchers, who are following all aspects of research, optimization and planning of all kind of functional electrical stimulation.

In addition the IFESS 2008 gives you a unique opportunity for recruiting. More than 100 PhD students from the leading labs of the world will attend the conference.

Who should exhibit?

- Suppliers of electrical stimulation equipment
- Suppliers of prosthetics and rehabilitation robotics
- Suppliers of vision prostheses and hearing aids

- Suppliers of implants and prostheses for
 - deep brain stimulation
 - neural stimulation to treat Epilepsy and Psychiatric Disorders
 - neuromodulation of Pain and Spasticity
 - electrical stimulation of Upper and Lower Extremities
- Suppliers of testing and service equipment
- Suppliers of measurement, monitoring and OSS equipment

Exhibitors Benefits

We understand that a well-designed, spacious, and visually attractive exhibition hall promotes circulation and ensures exhibitors a successful venture. The program committee designs its conference sessions, coffee breaks, and special events to attract conference attendees to the exhibition floor located right in front of the session hall. A special reception with snacks and beverages on Sunday evening (September 21, 2008) provides an excellent opportunity to mingle in a relaxed setting.

Booth Space Rental

Exhibition Space (Industry clients)

Before July 15, 2008:	200,-€/sqm + 19% (VAT)
After July 15, 2008:	230,-€/sqm + 19% (VAT)

Exhibition Space (Non-Profit organisations)

Before July 15, 2008:	140,-€/sqm + 19% (VAT)
After July 15, 2008:	170,-€/sqm + 19% (VAT)

Space cost include:

- Rental of space
- General illumination
- General cleaning
- Coffee breaks, lunch snacks, Welcome Reception in the exhibition area on Sunday (September 21, 2008) as well as Get Together on Monday (September 22, 2008)

Space cost do not include:

- Shell scheme construction
- Internet access
- Access to the conference sessions
- Chair, table, phone, electricity supply

Each exhibitor brings along his own booth structure. Please note that all registrations of booth personnel to attend the conference must be purchased separately. Registrations for the full conference must be completed using the official registration form or using the online registration at: www.ifess2008.de.

Exhibitor Action Plan

Follow these four steps to make your attendance at IFESS 2008 a success!

1. Reserve Your Booth Space Early

Exhibition space at the the 13th Annual International FES Society Conference is available from 3 m x 3 m or multiples. Booths will be assigned on a first come, first served basis, only when the completed Exhibition Order Form as well as the full payment have been received at VDE Conference Services. All Order Forms received on or before July 15, 2008 will be charged the early rate. Please indicate your preference by using the booth number given in the floor plans.

2. Reserve Your Hotel Accommodation

The VDE Conference Service arranged contingent reservations via Freiburg Tourismus & Marketing. For more details please have a look at the conference website www.ifess2008.de.

3. Watch for Exhibitor Updates

Watch your e-mail and the homepage www.ifess2008.de for updates on activities to prepare for the conference.

4. Invite Your Potential Clients

Invite existing and potential clients to visit the exhibition area. Use this opportunity to advertise new clients from the conference attendees to learn more about your products. Furthermore the IFESS 2008 is an ideal opportunity for recruitment of high potential scientists!

For more information on exhibiting at IFESS 2008 and sponsorship opportunities, please contact the Congress Secretariat or have a look at the Congress homepage www.ifess2008.de.